Appendix G-14 Part 1 – Consultation Materials: Missing Preliminary Environmental Information Report Figures

Great Yarmouth Third River Crossing - Stage 3 (Statutory pre-application) Consultation Preliminary Environmental Information Report (PEIR) Index of Missing Figures

Figure	Description
Figure 8.3: Bat Survey Area	1 plan showing the proposed locations of bat surveys, including internal roost inspections, listening points and activity transects. (See Table 8.3 of PEIR Volume 1)
Figure 8.4: Water Vole Survey Area	1 plan showing the proposed locations for surveys to identify the presence of water voles. (See Table 8.3 of PEIR Volume 1)
Figure 8.5: Bird Survey Area	1 plan showing the proposed locations for surveys to identify the presence and species of birds. (See Table 8.3 of PEIR Volume 1)
Figure 8.6: Statutory Designated Sites	1 plan showing the locations of Statutory designated conservation sites such as Sites of Special Scientific Interest. (See Section 8.4.3 to 8.4.4 of PEIR Volume 1)
Figures 9.1 and 9.1a: Designated Heritage Assets	2 plans showing the locations of designated cultural heritage features (e.g. Conservation Areas, Listed Buildings and Scheduled Monuments) within a 1km study area of the Proposed Scheme. (See Sections 9.1.1 to 9.1.4 of PEIR Volume 1)
Figure 9.2: Non-Designated Heritage Assets	1 plan showing the locations of non-designated cultural heritage features within 500m of the Proposed Scheme (See Sections 9.1.1 to 9.1.4 of PEIR Volume 1). Non-designated cultural heritage assets include features identified as having a degree of significance, meriting consideration in planning decisions but which are not formally designated.
Figure 9.3a to 9.3f: Heritage Assets (Designated and Non-Designated): Proposed VMS Locations	6 plans showing the locations of both designated and non-designated cultural heritage features within 250m of the proposed electronic variable message traffic signs. (See Sections 9.1.1 to 9.1.4 of PEIR Volume 1)
Figure 9.3g: Heritage Assets (Designated): Proposed Large Vessel Waiting Facility	1 plan showing the locations of both designated and non-designated cultural heritage features within 250m of the proposed large vessel waiting facility. (See Sections 9.1.1 to 9.1.4 of PEIR Volume 1)
Figure 10.1: Proposed Viewpoint Locations	1 plan showing the locations used for assessment of the visual impact of the Proposed Scheme. (See Sections 10.3.34 to 10.3.36 of PEIR Volume 1)
Figure 10.2: Proposed Viewpoint Locations	1 plan showing the locations used for assessment of the visual impact of the Proposed Scheme. (See Sections 10.3.34 to 10.3.36 of PEIR Volume 1)
Figure 10.3: Proposed Study Area	1 plan showing the overall study area for assessment of the visual impact of the Proposed Scheme. (See Chapter 10 of PEIR Volume 1)
Figure 11.1: Water Environment Key Features	1 plan showing the overall study area for assessment of the drainage and groundwater impacts of the Proposed Scheme. (See Chapter 11 of PEIR Volume 1)
Figure 12.1: Flood Risk Study Area	1 plan showing the overall study area for assessment of the flood risk impacts of the Proposed Scheme. (See Chapter 12 of PEIR Volume 1)
Figure 12.2: EA Flood Map for Planning	1 plan showing the Environment Agency designated flood risk zones. (See Sections 12.4.1 to 12.4.6 of PEIR Volume 1)
Figure 17.1: Transport Assessment Study Area	1 plan showing the overall study area for assessment of the transport impact of the Proposed Scheme. (See Chapter 14 of PEIR Volume 1)

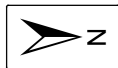
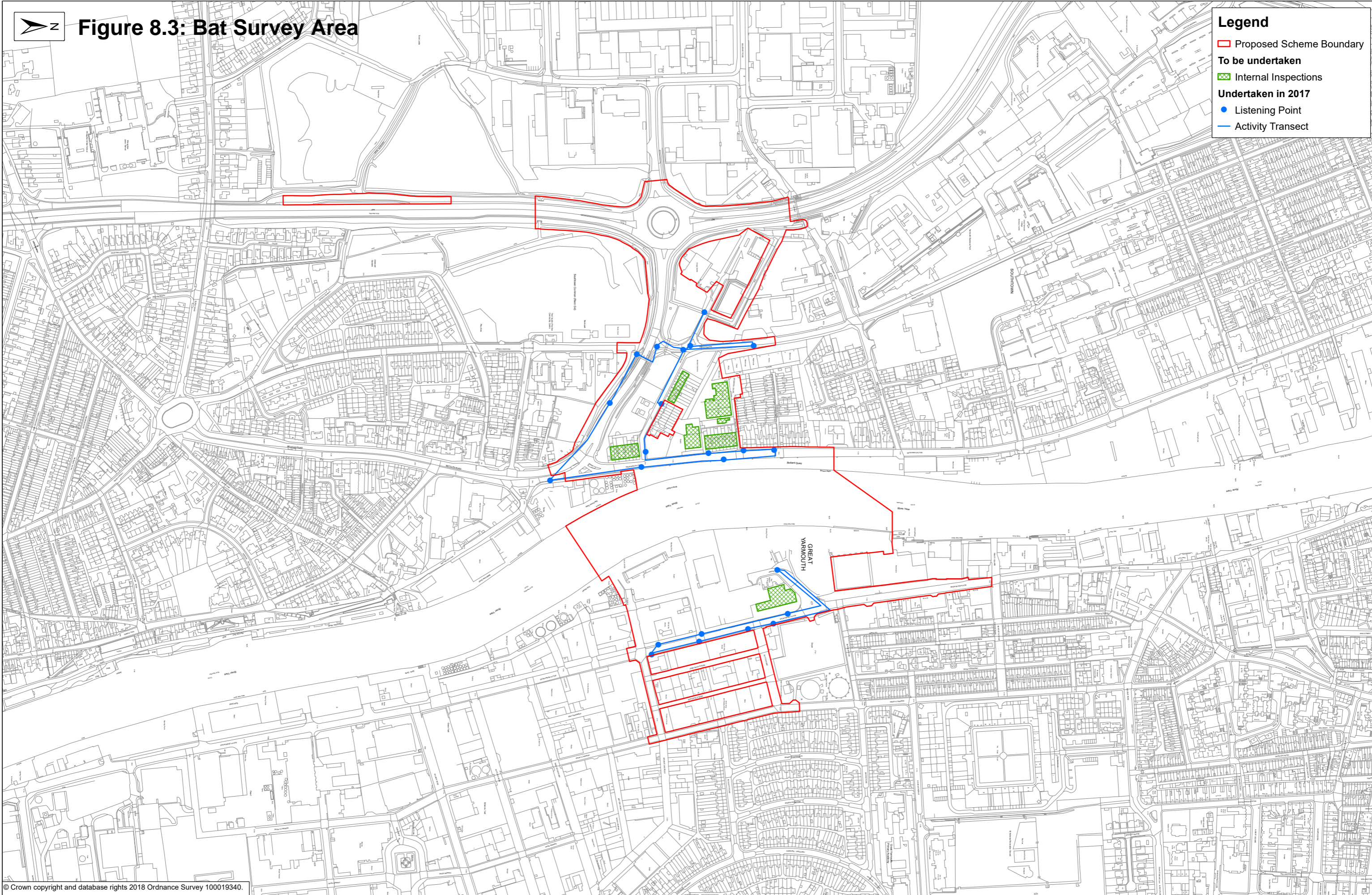

Figure 8.3: Bat Survey Area

Legend

- Proposed Scheme Boundary
- To be undertaken
- Internal Inspections
- Undertaken in 2017
- Listening Point
- Activity Transect



© Crown copyright and database rights 2018 Ordnance Survey 100019340.

Norfolk County Council

Tom McCabe
Executive Director of
Community and Environmental Services
Norfolk County Council
County Hall, Martineau Lane
Norwich NR1 2SG



DRAWING TITLE

Figure 8.3 Bat Survey Area

REV.	DESCRIPTION	CHECKED	DATE
A	INITIAL ISSUE	JD	13/07/18

DESIGNED BY	INITIALS	DATE	DRAWING No.
	-	-	GYTRC-WSP-EBD-XX-DR-EC-0003
DRAWN BY	BS	16/10/2018	PROJECT TITLE
CHECKED BY	DE	16/10/2018	GREAT YARMOUTH THIRD RIVER CROSSING
APPROVED BY	JD	16/10/2018	SCALE
			1:2,500@A1
			FILE No.



Figure 8.4: Water Vole Survey Area

Legend

- Proposed Scheme Boundary
- Area Surveyed - 2017
- Area to be Surveyed - 2018

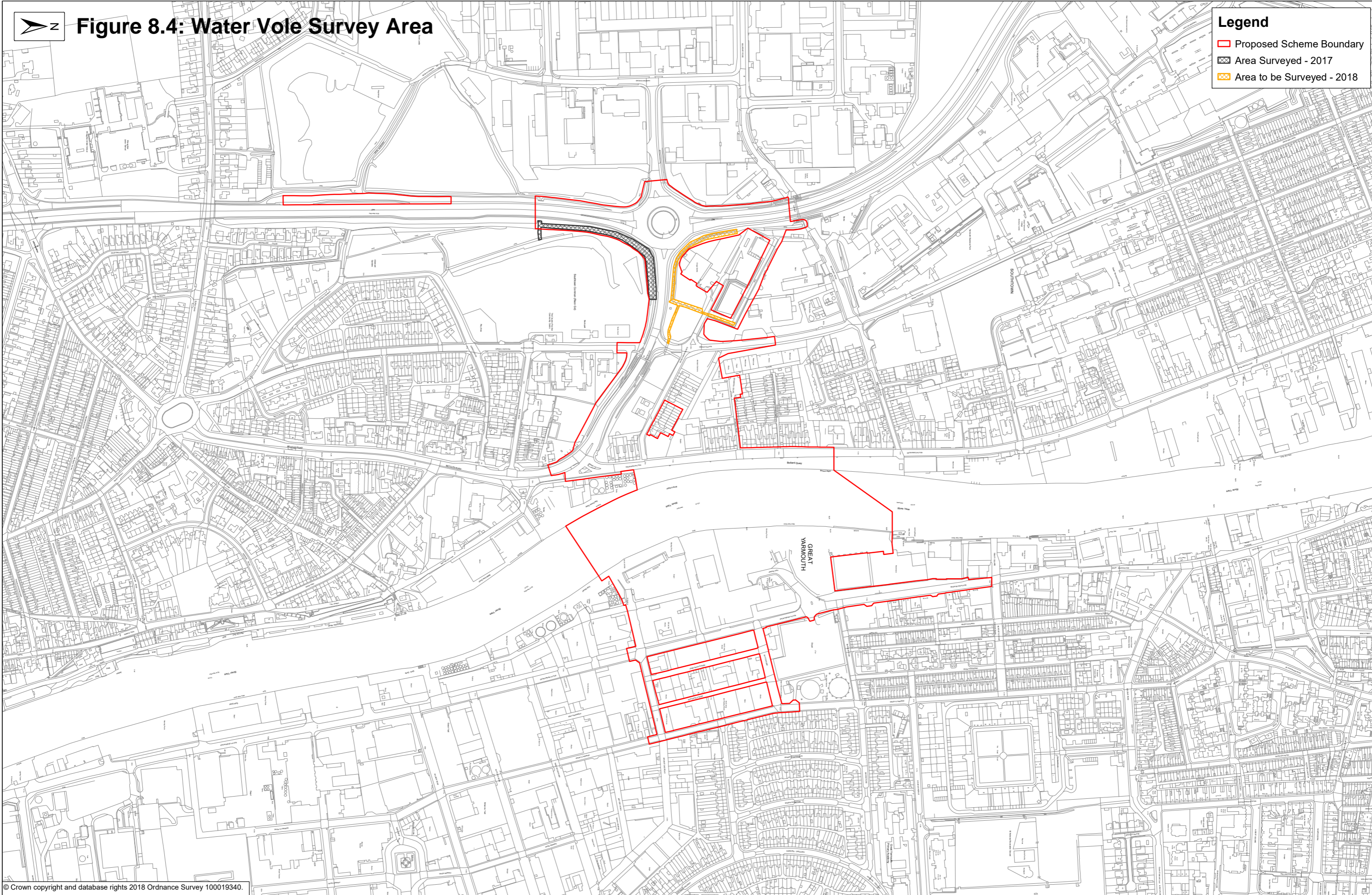

© Crown copyright and database rights 2018 Ordnance Survey 100019340.

Norfolk County Council
 Tom McCabe
 Executive Director of
 Community and Environmental Services
 Norfolk County Council
 County Hall, Martineau Lane
 Norwich NR1 2SG



DRAWING TITLE
 Figure 8.4 Water Vole Survey Area

REV.	DESCRIPTION	CHECKED	DATE
A	INITIAL ISSUE	JD	13/07/18

DESIGNED BY	INITIALS	DATE	DRAWING No.
	-	-	GYTRC-WSP-EBD-XX-DR-EC-0004
DRAWN BY	BS	16/10/2018	PROJECT TITLE
CHECKED BY	DE	16/10/2018	GREAT YARMOUTH THIRD RIVER CROSSING
APPROVED BY	JD	16/10/2018	SCALE
			1:2,500@A1
			FILE No.



Figure 8.5: Bird Survey Area

Legend

- Proposed Scheme Boundary
- Bird Survey Area

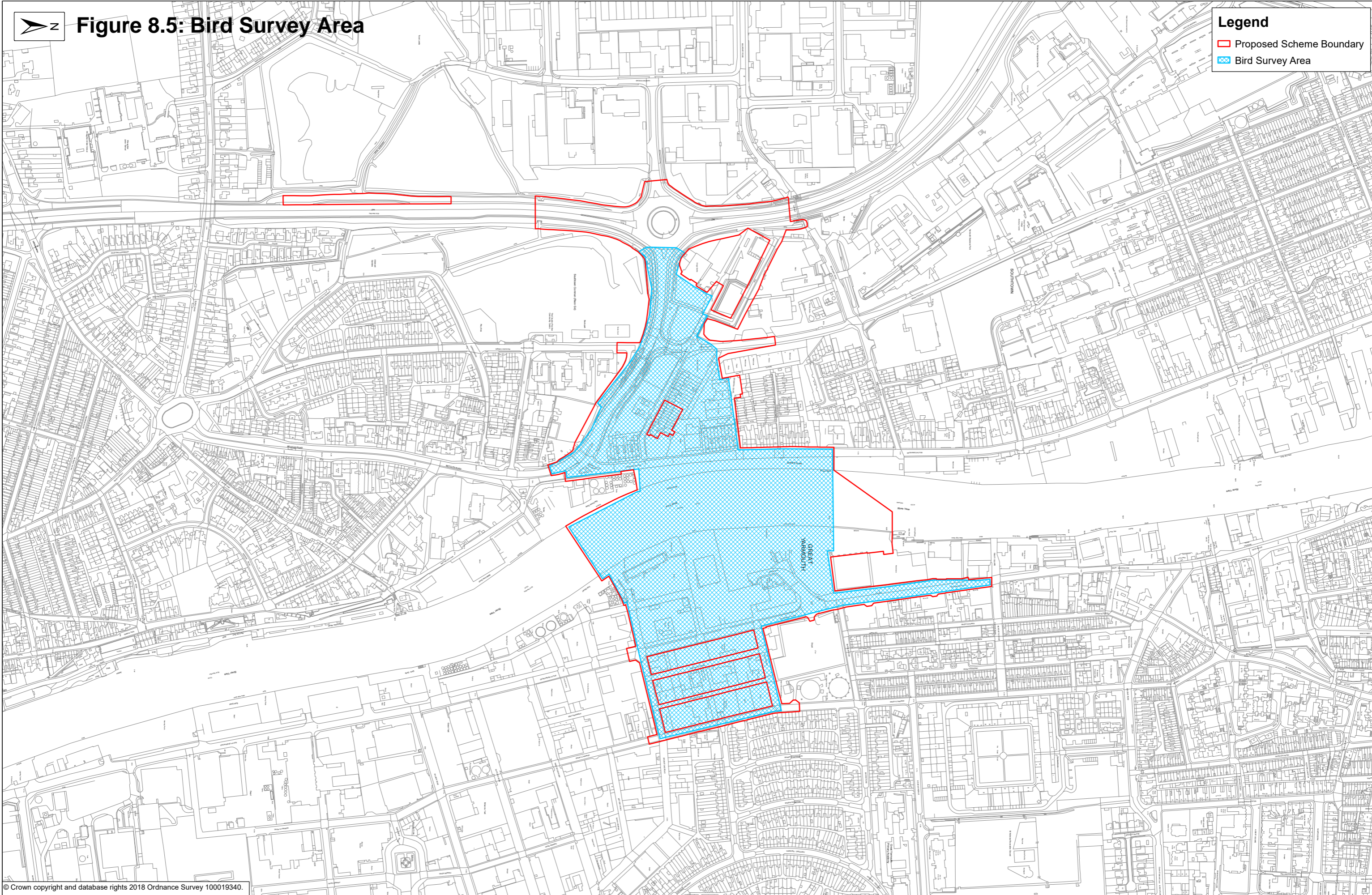

© Crown copyright and database rights 2018 Ordnance Survey 100019340.

Norfolk County Council
 Tom McCabe
 Executive Director of
 Community and Environmental Services
 Norfolk County Council
 County Hall, Martineau Lane
 Norwich NR1 2SG



DRAWING TITLE
 Figure 8.5 Bird Survey Area

REV.	DESCRIPTION	CHECKED	DATE
A	INITIAL ISSUE	JD	13/07/18

DESIGNED BY	INITIALS	DATE	DRAWING No.
	-	-	GYTRC-WSP-EBD-XX-DR-EC-0005
DRAWN BY	BS	17/10/2018	PROJECT TITLE
CHECKED BY	DE	17/10/2018	GREAT YARMOUTH THIRD RIVER CROSSING
APPROVED BY	JD	17/10/2018	SCALE
			1:2,500@A1
			FILE No.



Figure 8.6: Statutory Designated Sites

Legend

- Proposed Scheme Boundary
- Survey Area
- Site of Special Scientific Interest (SSSI)
- National Park
- Special Protection Area (SPA)

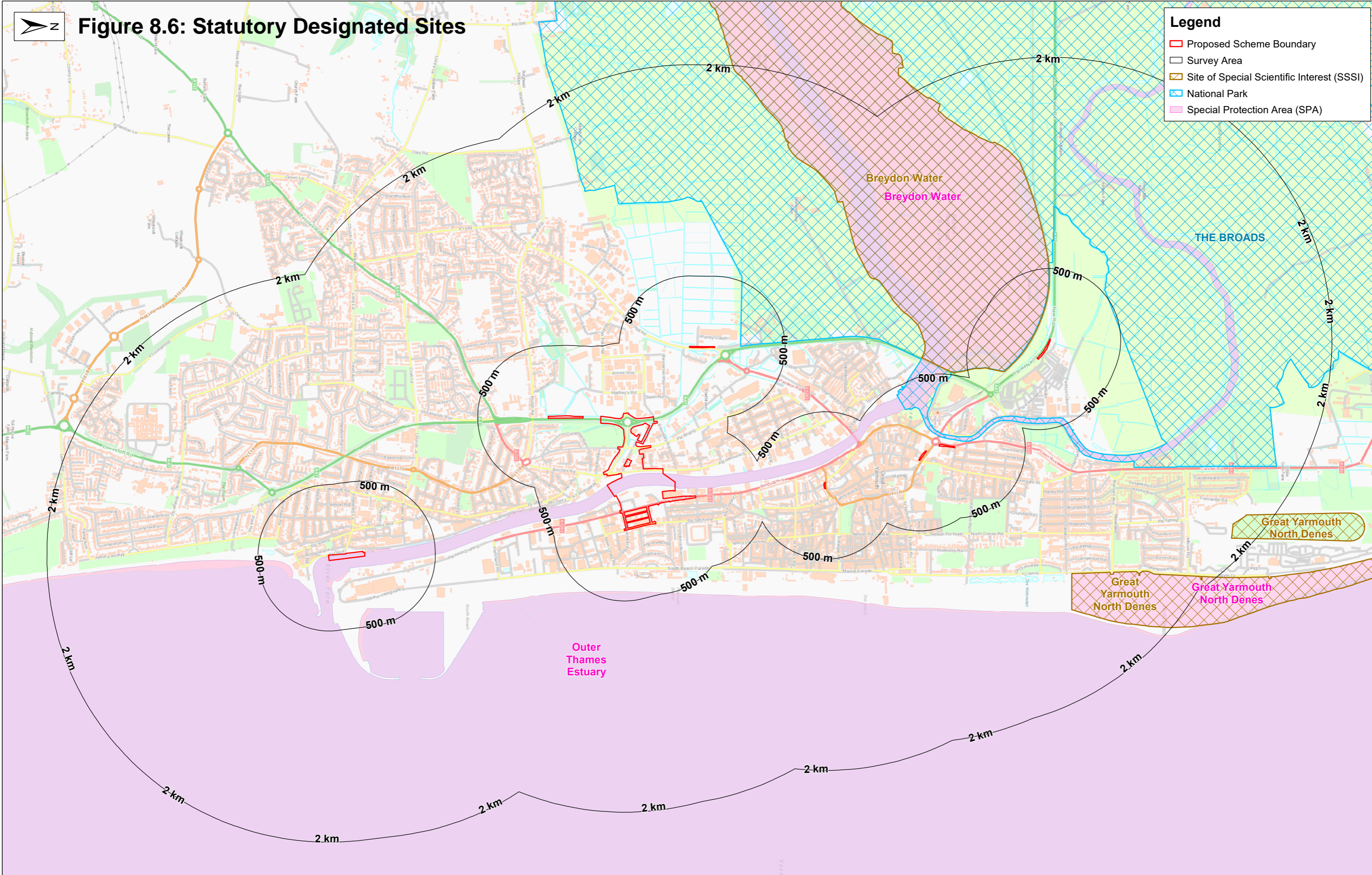

© Crown copyright and database rights 2018 Ordnance Survey 100019340.

Norfolk County Council
 Tom McCabe
 Executive Director of
 Community and Environmental Services
 Norfolk County Council
 County Hall, Martineau Lane
 Norwich NR1 2SG



DRAWING TITLE
Figure 8.6 Statutory Designated Sites

REV.	DESCRIPTION	CHECKED	DATE
A	INITIAL ISSUE	JD	13/07/18

DESIGNED BY	INITIALS	DATE	DRAWING No.
	-	-	GYTRC-WSP-EBD-XX-DR-EC-0006
DRAWN BY	BS	16/10/2018	PROJECT TITLE
CHECKED BY	DE	16/10/2018	GREAT YARMOUTH THIRD RIVER CROSSING
APPROVED BY	JD	16/10/2018	SCALE
			1:12,000@ A1
			FILE No.



Figure 9.1: Designated Heritage Assets

- KEY**
- Listed Buildings**
- Grade**
- ▲ Grade I
 - ▲ Grade II
 - ▲ Grade II*
- ▭ Proposed Scheme Boundary
 - ▨ Conservation Areas
 - ▭ Scheduled Monument
 - 1 KM Study Area

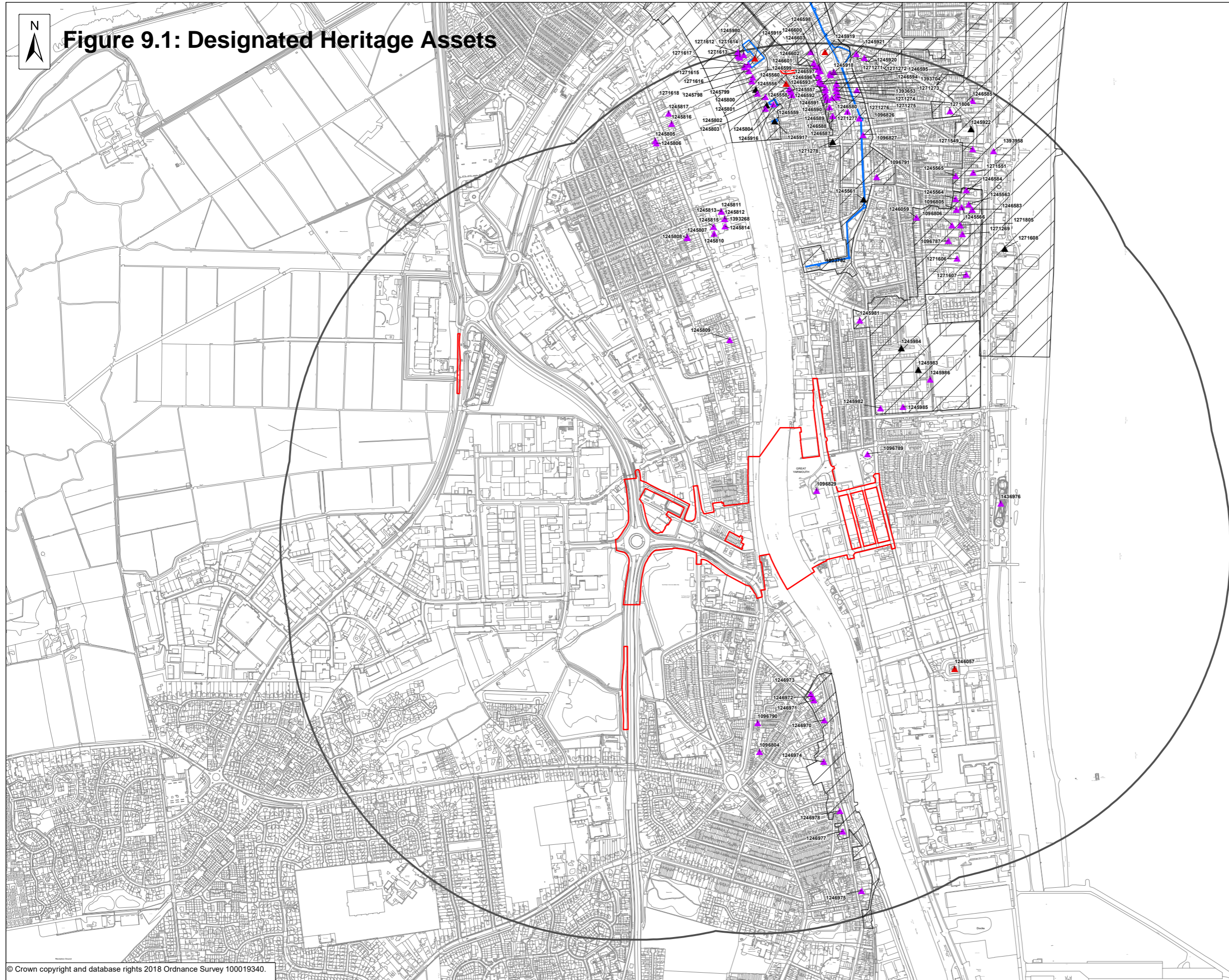

© Crown copyright and database rights 2018 Ordnance Survey 100019340.

REV.	DESCRIPTION	CHECKED	DATE
01	INITIAL ISSUE	JD	13/07/2018

DESIGNED BY	INITIALS	DATE	DRAWING No.
AG	AG	16/10/2018	GYTRC-WSP-HER-XX-DR-AR-0001
DRAWN BY	RH	16/10/2018	PROJECT TITLE
CHECKED BY	JD	16/10/2018	GREAT YARMOUTH THIRD RIVER CROSSING
APPROVED BY	JD	16/10/2018	SCALE 1:5,500 @ A1 FILE No.

Figure 9.3a: Heritage Assets (Designated and Non-Designated): Proposed VMS Locations

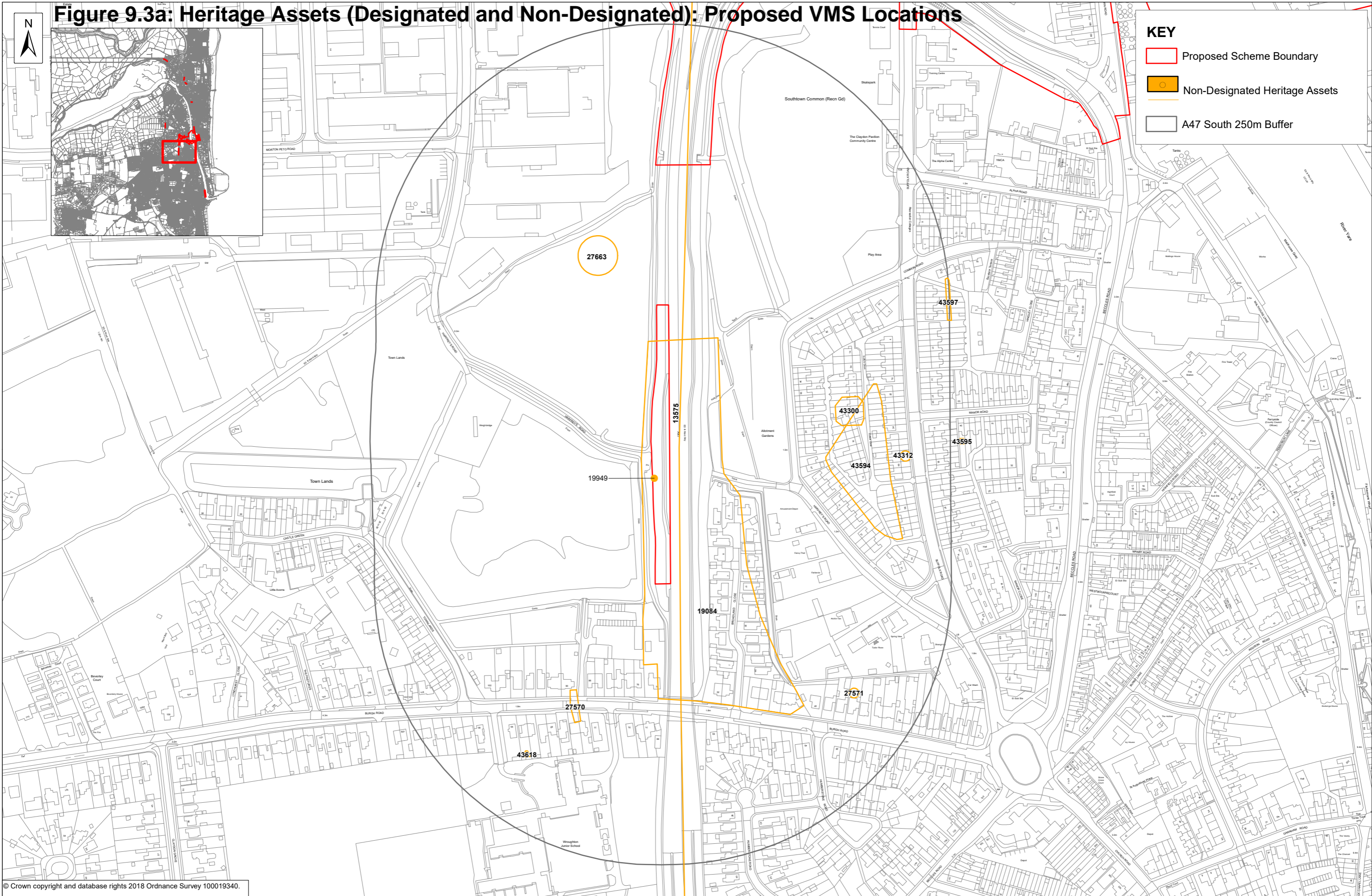

KEY

- Proposed Scheme Boundary
- Non-Designated Heritage Assets
- A47 South 250m Buffer

© Crown copyright and database rights 2018 Ordnance Survey 100019340.

Norfolk County Council
 Tom McCabe
 Executive Director of
 Community and Environmental Services
 Norfolk County Council
 County Hall, Martineau Lane
 Norwich NR1 2SG



DRAWING TITLE
 Figure 9.3a – Heritage Assets (Designated and Non-Designated): Proposed VMS Locations

REV.	DESCRIPTION	CHECKED	DATE
01	INITIAL ISSUE	JD	13/07/2018

DESIGNED BY	INITIALS	DATE	DRAWING No.
AG	AG	16/10/2018	GYTRC-WSP-HER-XX-DR-AR-0004
RH	RH	16/10/2018	PROJECT TITLE
JD	JD	16/10/2018	GREAT YARMOUTH THIRD RIVER CROSSING
JD	JD	16/10/2018	SCALE
			1:1,500 @ A1
			FILE No.

Figure 9.3b: Heritage Assets (Designated and Non-Designated): Proposed VMS Locations



KEY

- Acle Road 250m Buffer
- Proposed Scheme Boundary

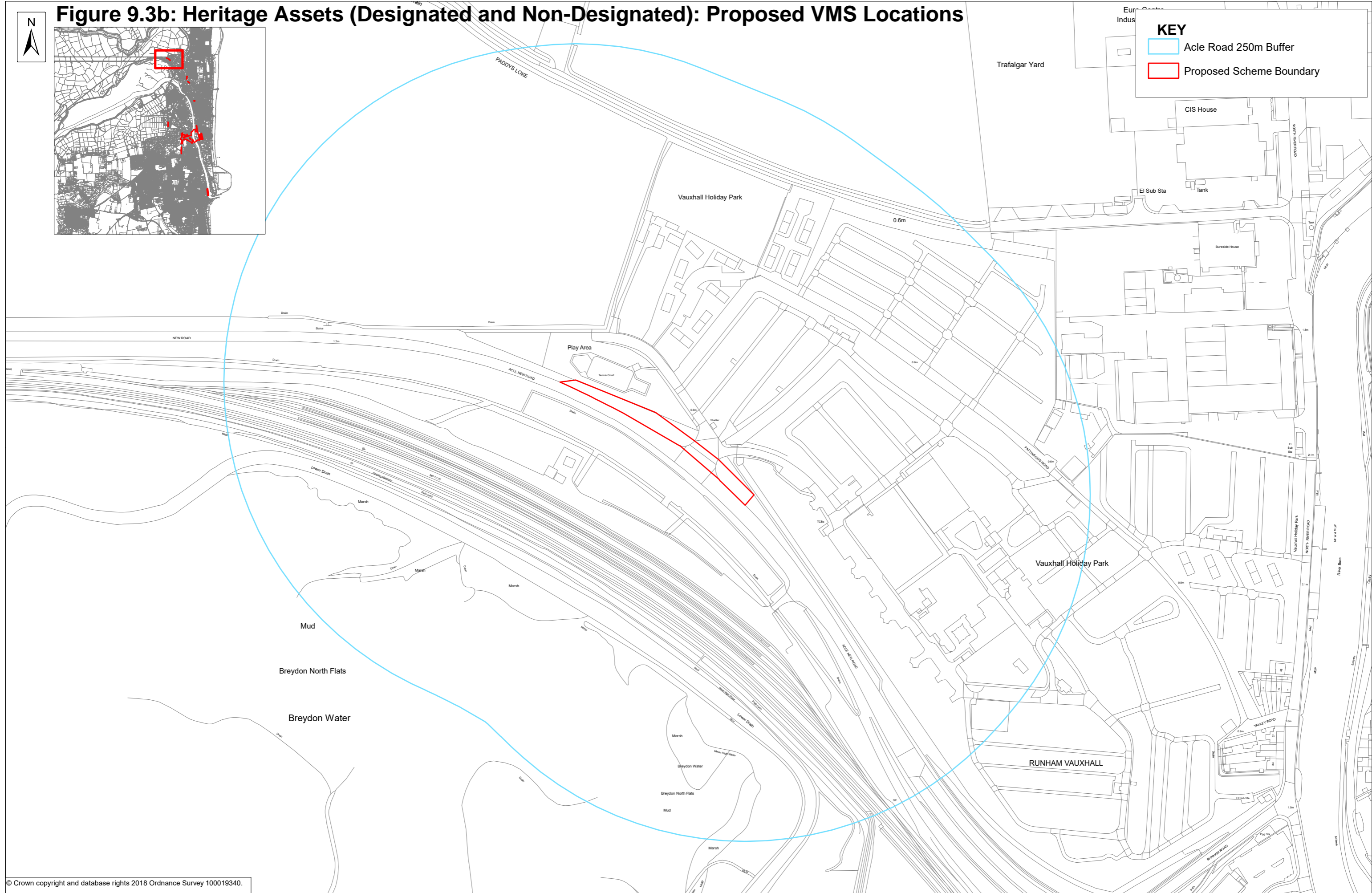

© Crown copyright and database rights 2018 Ordnance Survey 100019340.

REV.	DESCRIPTION	CHECKED	DATE
01	INITIAL ISSUE	JD	13/07/2018

DESIGNED BY	INITIALS	DATE
AG	AG	16/10/2018
RH	RH	16/10/2018
JD	JD	16/10/2018
JD	JD	16/10/2018

DRAWING No.	GYTRC-WSP-HER-XX-DR-AR-0005
PROJECT TITLE	GREAT YARMOUTH THIRD RIVER CROSSING
SCALE	1:1,250 @ A1
FILE No.	

Figure 9.3c: Heritage Assets (Designated and Non-Designated): Proposed VMS Locations



KEY

Listed Buildings

- ▲ Grade I
- ▲ Grade II
- ▲ Grade II*

▭ Proposed Scheme Boundary

▭ Fullers Way 250m Buffer

▭ Designated Heritage Assets

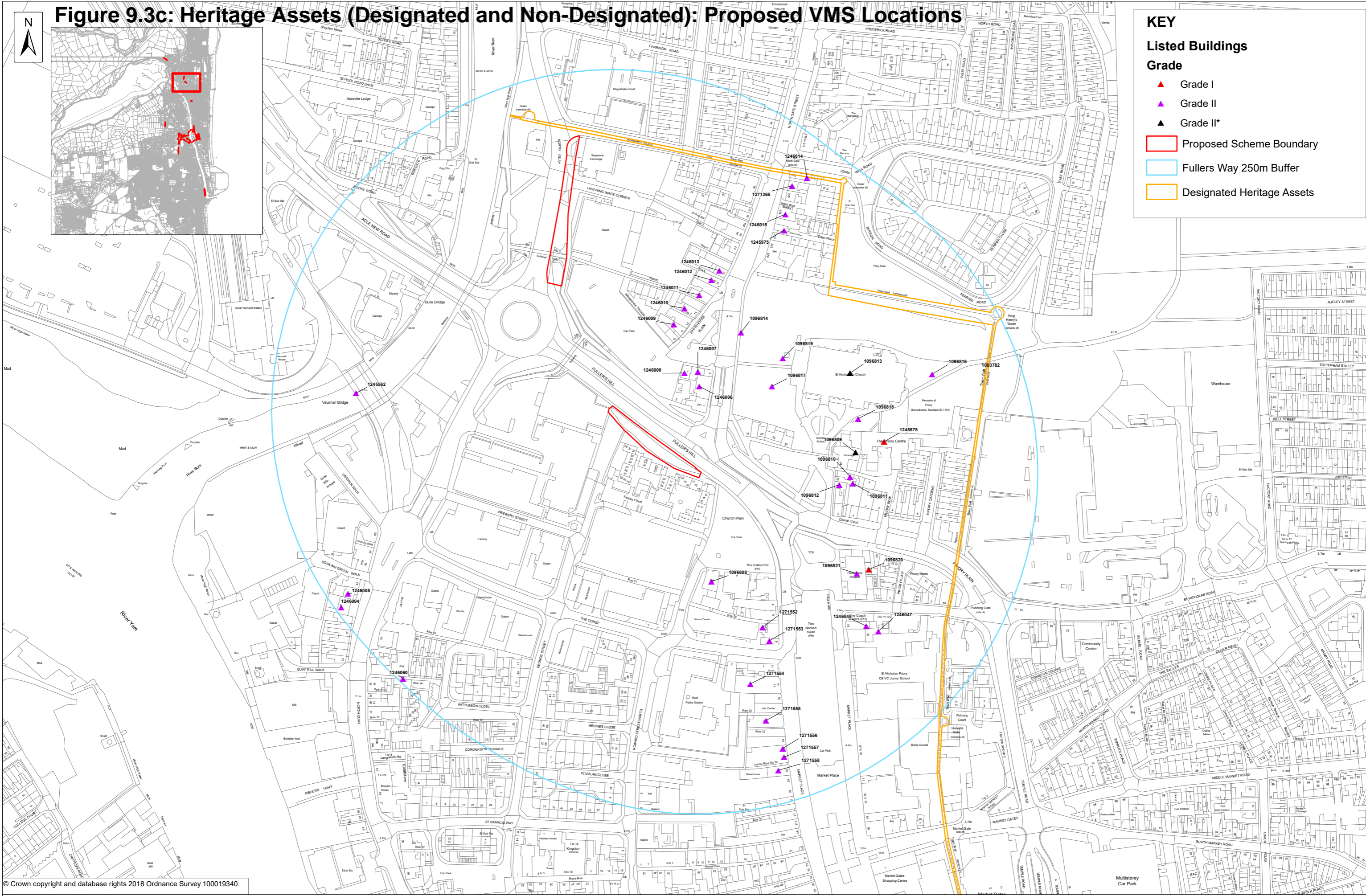

© Crown copyright and database rights 2018 Ordnance Survey 100019340.

Norfolk County Council

Tom McCabe
Executive Director of
Community and Environmental Services
Norfolk County Council
County Hall, Martineau Lane
Norwich NR1 2SG



DRAWING TITLE

Figure 9.3c – Heritage Assets (Designated and Non-Designated): Proposed VMS Locations

REV.	DESCRIPTION	CHECKED	DATE
01	INITIAL ISSUE	JD	13/07/2018

DESIGNED BY	INITIALS	DATE
AG	AG	16/10/2018
DRAWN BY	RH	16/10/2018
CHECKED BY	JD	16/10/2018
APPROVED BY	JD	16/10/2018

DRAWING No.	GYTRC-WSP-HER-XX-DR-AR-0006
PROJECT TITLE	GREAT YARMOUTH THIRD RIVER CROSSING
SCALE	1:1,250 @ A1
FILE No.	

Figure 9.3d: Heritage Assets (Designated and Non-Designated): Proposed VMS Locations

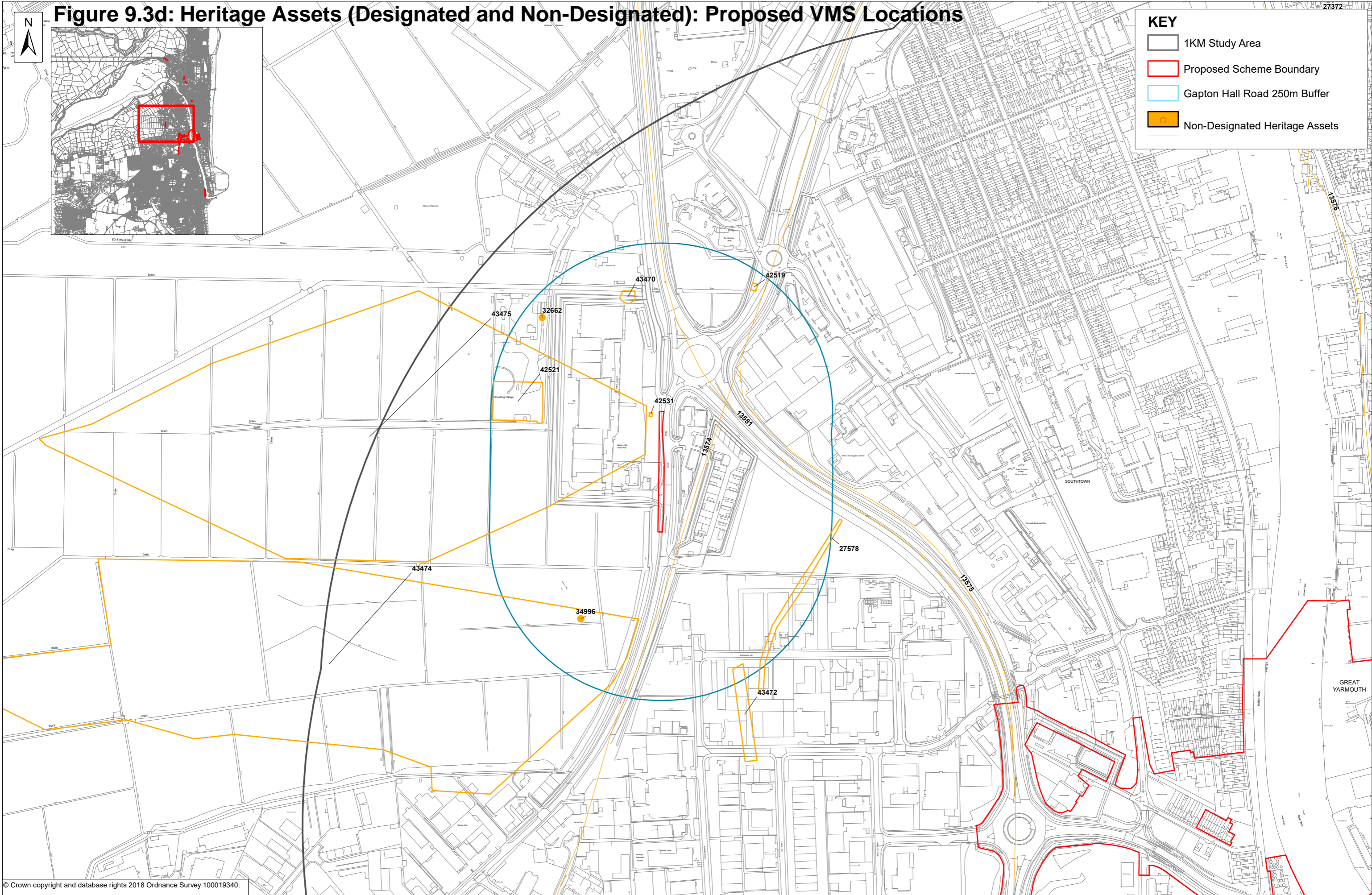

KEY

- 1KM Study Area
- Proposed Scheme Boundary
- Garton Hall Road 250m Buffer
- Non-Designated Heritage Assets

© Crown copyright and database rights 2018 Ordnance Survey 100019340.

Norfolk County Council
 Tom McCabe
 Executive Director of
 Community and Environmental Services
 Norfolk County Council
 County Hall, Martineau Lane
 Norwich NR1 2SG



DRAWING TITLE
 Figure 9.3d – Heritage Assets (Designated and Non-Designated): Proposed VMS Locations

REV.	DESCRIPTION	CHECKED	DATE
01	INITIAL ISSUE	JD	13/07/2018

DESIGNED BY	INITIALS	DATE	DRAWING No.
AG	AG	16/10/2018	GYTRC-WSP-HER-XX-DR-AR-0007
DRAWN BY	RH	16/10/2018	PROJECT TITLE
CHECKED BY	JD	16/10/2018	GREAT YARMOUTH THIRD RIVER CROSSING
APPROVED BY	JD	16/10/2018	SCALE
			1:2,500 @ A1
			FILE No.

Figure 9.3e: Heritage Assets (Designated and Non-Designated): Proposed VMS Locations

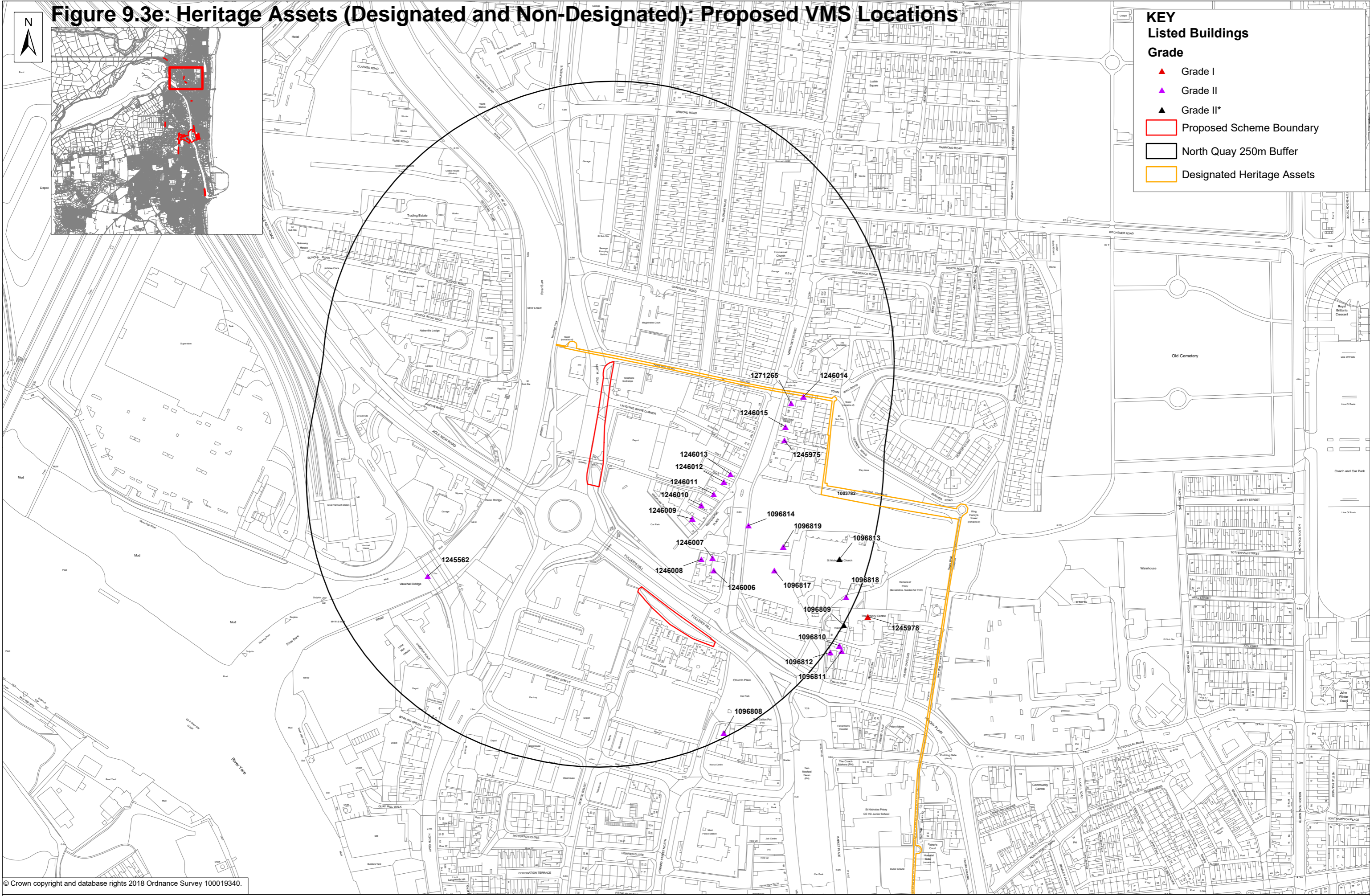

KEY

Listed Buildings

Grade

- ▲ Grade I
- ▲ Grade II
- ▲ Grade II*

▭ Proposed Scheme Boundary

○ North Quay 250m Buffer

▭ Designated Heritage Assets

© Crown copyright and database rights 2018 Ordnance Survey 100019340.

Norfolk County Council

Tom McCabe
Executive Director of
Community and Environmental Services
Norfolk County Council
County Hall, Martineau Lane
Norwich NR1 2SG



DRAWING TITLE

Figure 9.3e – Heritage Assets (Designated and Non-Designated): Proposed VMS Locations

REV.	DESCRIPTION	CHECKED	DATE
01	INITIAL ISSUE	JD	13/07/2018

DESIGNED BY	INITIALS	DATE	DRAWING No.
AG	AG	16/10/2018	GYTRC-WSP-HER-XX-DR-AR-0008
DRAWN BY	RH	16/10/2018	PROJECT TITLE
CHECKED BY	JD	16/10/2018	GREAT YARMOUTH THIRD RIVER CROSSING
APPROVED BY	JD	16/10/2018	SCALE
			1:1,500 @ A1
			FILE No.

Figure 9.3g: Heritage (Designated): Proposed Large Vessel Waiting Facility



KEY

Listed Buildings

Grade

- ▲ Grade I
- ▲ Grade II
- ▲ Grade II*

▭ 1KM Study Area

▭ Proposed Scheme Boundary

▭ Emergency Layby 250m Buffer

▭ Conservation Areas

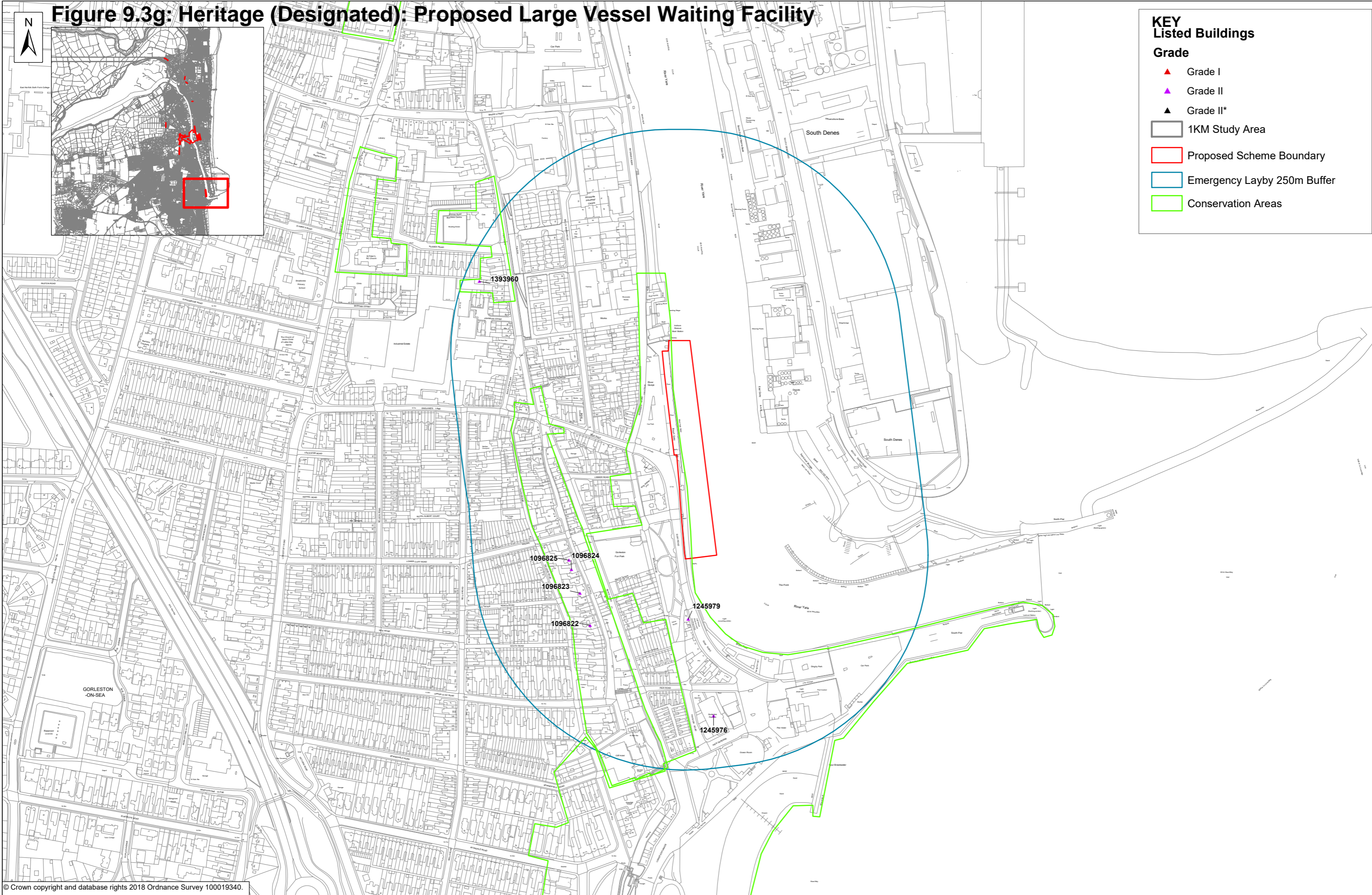

© Crown copyright and database rights 2018 Ordnance Survey 100019340.

Norfolk County Council
 Tom McCabe
 Executive Director of
 Community and Environmental Services
 Norfolk County Council
 County Hall, Martineau Lane
 Norwich NR1 2SG



DRAWING TITLE
 Figure 9.3g – Heritage (Designated): Proposed
 Emergency Layby

REV.	DESCRIPTION	CHECKED	DATE
01	INITIAL ISSUE	JD	13/07/2018

DESIGNED BY	INITIALS	DATE	DRAWING No.
AG	AG	16/10/2018	GYTRC-WSP-HER-XX-DR-AR-0010
RH	RH	16/10/2018	PROJECT TITLE GREAT YARMOUTH THIRD RIVER CROSSING
JD	JD	16/10/2018	
JD	JD	16/10/2018	SCALE 1:2,000 @ A1
			FILE No.